

INSTALLATION AND MAINTENANCE INSTRUCTIONS VB21 – VB21M – VB16 - VACUUM BREAKER

GENERAL

- These instructions must be carefully read before any work involving products supplied by VALSTEAM ADCA ENGINEERING S.A. is undertaken.
- The installation procedure is a critical stage in a life of a vacuum breaker and care should be taken to avoid damage to the valve or equipment.
- Vacuum breakers are designed to automatically relieve or “break” an unwanted vacuum condition, restoring the atmospheric pressure.

Note:

- Current regional safety regulations should be take in to account and followed, while doing the installation and maintenance work.
- Handling, installation and maintenance work must be carried out by trained personnel. A supervisor must follow and check all activities.
- For the problems that cannot be solve with the help of this instructions, please contact the supplier or the manufacturer.
- The manufacturer reserves the right to change the design and material of this product without notice.

CE Marking:

This product has been designed for use on steam and water which are in Group 2 of the PED-European Pressure Equipment Directive 97/23/EC and it comply with those requirements.
The product fall within category SEP and must not be CE marked.



ATTENTION

- At start up, the presence of small particles in the system (dirt, scale, weld splatters, etc) may cause an imperfect closure of the seat. If this occurs, proceed to an accurate cleaning.
- Do not touch the equipment without appropriate protection during working operation because it may conduct heat if the used fluid is at high temperature.
- Before starting maintenance be sure that the equipment is not pressurized or hot.
- The equipments must be used within the working temperature and pressure limits laid down for them, otherwise they may fail (refer to nameplate and/or IS- Information Sheet).
- Do not remove the nameplate or marking of the equipment. Serial number and other useful information is stamped on it.

TRANSPORT AND STORAGE



ATTENTION

- The valves and equipments should be protected from impacts and forces during transportation and storage.
- The manufacturer doesn't assume the responsibility of damaged equipments due to inappropriate handling during the transportation and storage.

INSTALLATION



ATTENTION

- Account for over pressure conditions, according with the local laws or standards.
- For the problems that cannot be solve with the help of this instructions, please contact the supplier or the manufacturer.

Installation area requirements:

- The installation area should have easy access and provide enough space for maintenance and removing operations.

Procedure:

- Before to install remove plastic covers placed on flanges or connection ends. The equipment has an arrow or Inlet/Outlet designations. Be sure that it will be installed on the appropriate direction.
- The VB must be installed in a vertical position with the system connection at the bottom.

Periodical checking:

- 24 hours after the start up, it is recommended to check pipe connections for leaks and retighten the connections if necessary.

MAINTENANCE

- The ADCA vacuum breakers do not require any particular maintenance. They should be checked periodically (at least yearly) to verify they are operating correctly and to clean internal parts. The internals cleaning depend on the degree of contamination of the fluid.
- For the VB21, we recommend the ball valve and seat examination, to ascertain the extend of the damage or service wear.
- For the VB16, we recommend the valve seat and viton sealing inspection and replacement, if required.
- For further information refer to the relevant IS (Information Sheet) or consult our Sales Office.

VB21 - LIMITING CONDITIONS	
PMO: Max. operating pressure	21 bar
TMO: Max. operating temperature	220°C

VB16 - LIMITING CONDITIONS	
PMO: Max. operating pressure	16 bar
TMO: Max. operating temperature	120°C

PARTS LIST FOR VB21 – VB21M VACUUM BREAKER:

CODE	DESIGNATION	TRAP SIZE DN	POS.NR.	QTY.
A.95.5500.015	Ball valve	DN1/2"	3	1

Recommended tightening torques:

POS.NR.	TRAP SIZE DN	Nm
Nrs.2	DN 1/2"	150

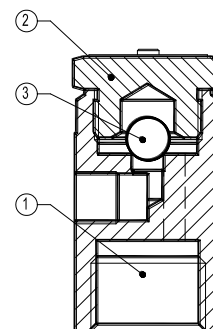
PARTS LIST FOR VB16 – VACUUM BREAKER:

CODE	DESIGNATION	TRAP SIZE DN	POS.NR.	QTY.
-	Valve seat	DN1/2"-1"	2	1

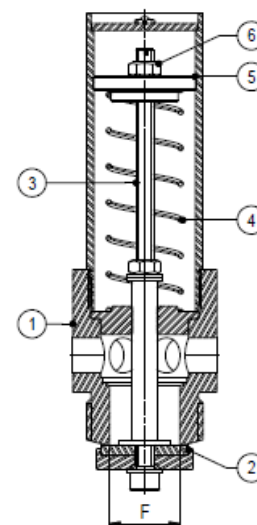
ATTENTION

- **LOSS OF WARRANTY:** Total or partial disregard of above instructions involves loss of any right to warranty.